A woman with long brown hair, wearing a white trench coat, is shown in profile, reaching up to a high shelf in a brightly lit supermarket. She is holding a small, colorful product. The background is filled with various products on shelves, creating a sense of a well-stocked store. The lighting is warm and focused on the woman and the product she is reaching for.

REFRIGERATION LIGHTING SHELF DISPLAY LIGHTING LED PROFILE

ABOUT US

LUXX Lichttechnik GmbH / LUXX Light Technology Ltd. represents a German headquartered international group with lighting competence and innovations since over 20 years.

Our core competences:

- Research & Development
- Design
- Manufacturing
- Quality Assurance
- Cost Control

LUXX is dedicated to slim and energy efficient linear lighting fixtures since 1997.

1997 — CCFL (cold cathode fluorescent lamp) slim and energy efficient linear lighting fixtures

2006 — LED ultraslim and energy efficient linear lighting fixtures

2012 — all LED Commercial Lighting fixtures and replacements

2013 — LED Industrial Lighting fixtures

Since 2014 LUXX presents the latest edition:

- LED refrigeration equipment lighting — freezers, coolers, chillers, cabinets
- LED fresh food lighting — cabinets, shelves and displays
- LED vending machine lighting
- LED shelf- and rack lighting

Part of LUXX Group

LUXX Light Technology

LEDtec

LIGHTPANEL

www.luxx.com | www.luxx.cn

www.ledtec.eu | www.ledtec.co.uk

www.lightpanel.us

All LUXX refrigeration and food lighting fixtures are made using the latest LED technology, which saves double on energy costs:

- 1) LED light saves already up to 70% energy
- 2) Freezers need less cooling power because of a lower heat generation due to high efficiency

LUXX signature design:

Most of our business is OEM. We are happy to assist you in integrating our lighting technology into your appliances. Our team creates the most effective and advanced design using the latest technologies.

TRUE COLOR tech:

For the perfect presentation of different kinds of food, specially selected light colors are necessary. But not only the color temperature plays an important role, values of color temperature, color rendering and color locations need to be optimally tuned to ensure the successful high-lighting of different kinds of fresh products.

Nearly all of our products are also available in special light colors for meat, cheese, bread, fish, fruits and vegetables.



LUXX Light Technology

TRUE

COLOR^{tech}



CONTENTS

REFRIGERATION LIGHTING

- CANNES
- DUO CANNES
- NIZZA LINEAR
- MONZA LINEAR
- MILANO SLIM
- MILANO SLIM CORNER
- SIENA
- MANTUA

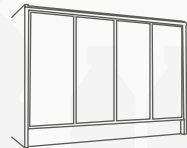

SHELF LIGHTING

- 7 SHELF TAG LIGHT
- 8 SHELF TAG LIGHT
- 9 MONACO
- 10 ALU MONACO semi-linear
- 11 ALU MONACO SLIM
- 12 ROMA
- 13 SLIMLINE SM
- 14 SLIMLINE RM
- LAS VEGAS
- MONZA LINEAR
- NIZZA LINEAR
- MEMPHIS
- MIAMI SM
- MIAMI RM
- TORINO
- ALU CANNES linear
- CANNES
- ALINA
- LONG ISLAND

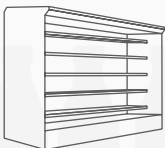

- 16
- 17
- 18
- 19
- 20
- 21
- 22
- 23
- 24
- 25
- 26
- 27
- 28
- 29
- 30
- 31
- 32
- 33
- 34

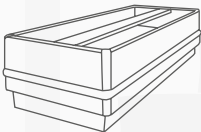

ACCESSORIES

POWER TRACK SYSTEM	35	TUBELINE ALU 16	55
IP54 CONNECTOR SYSTEM	36	MULTILINE ALU 16 semi linear	56
LED MINI CONNECTOR SYSTEM	37	CORNER LINE ALU 10 semi linear	57
XHP CONNECTOR SYSTEM	38	CORNER LINE ALU 16 semi linear	58
ADAPTING CABLE SYSTEM	39	CORNER LINE ALU 19 semi linear	59
		CORNER LINE ALU 30 semi linear	60
LED PROFILES		STYLELINE ALU 70	61
		FLOOR LINE ALU 9	62
TOPLINE ALU 6	41	TOPLINE PMMA 5	63
TOPLINE ALU 7 semi linear	42	CORNER LINE PMMA 10	64
INLINE ALU 8	43	LINEPROFIL 12	65
TOPLINE ALU 8	44	LINEPROFIL 14-8	66
INLINE ALU 11	45	LINEPROFIL 14-10	67
TOPLINE ALU 11	46	LINEPROFIL 14-12	68
INLINE ALU 10	47	LINEPROFIL 18	69
TOPLINE ALU 10	48	TOPLINE ALU 3511	70
INLINE ALU 12	49	CORNERLINE ALU 5917	71
TOPLINE ALU 12	50	CORNERLINE ALU -4128	72
INLINE ALU 15 semi linear	51	SUSLINE ALU 6826	73
TOPLINE ALU 15 semi linear	52	INLINE-7615	74
TOPLINE ALU 21 semi linear	53	INLINE ALU 5615	75
OPTIC LINE ALU 12	54	CORNERLINE ALU 4615	76
		CORNERLINE ALU 5315	77

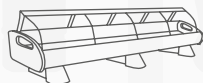

REFRIGERATION LIGHTING



CANNES

PMMA LED cooler lighting fixture

The quadrant lighting fixture can be adapted to any corner elegantly.

Food display versions are available.

Different configurations available upon request.

Specifications / data per meter

Electrical

Power: 9.6W / 14.4W (HB)

Input voltage: 12V / 24V DC

LED

Type: 2835

Q'ty: 120 pcs

CCT: 2700K- 6500K

CRI >80 Ra

Light Output

Beam angle: 120°

Efficiency: 110-120 Lm/W

Lumen: 1050 Lm (Clear) / 960 Lm (frosted)

Food Display Versions

Meat: CCT-Pink

Fish: CCT- 10000K

Vegetable&Fruit: CRI >97 Ra

Working temperature

-25°C/ -35°C to + 45°C

IP rating

IP 54

Appearance

Dimensions: L1000 x W10 x H10 mm

Max Length available: 3100 mm

Diffuser: clear / frosted

Accessories

Spring steel clips / magnetic tape

Wire exit

Linear + 90° x 3 ways out

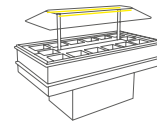
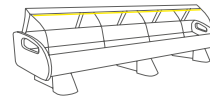
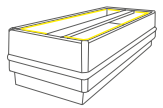
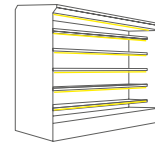
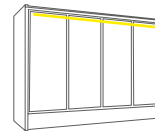

DUO CANNES

PMMA LED cooler lighting fixture

Duo Cannes can light up two sides of most refrigerators, chillers and cabinets.

Food display versions are available.

Different configurations available upon request.

Specifications / data per meter

Electrical

Power: 19.2W

Input voltage: 12V / 24V DC

LED

Type: 2835

Q'ty: 240 pcs

CCT: 2700K- 6500K

CRI >80 Ra

Light Output

Beam angle: 120°

Efficiency: 110-120 Lm/W

Lumen: 2125 Lm

Food Display Versions

Meat: CCT-Pink

Fish: CCT- 10000K

Vegetable&Fruit: CRI >97 Ra

Working temperature

-25°C/ -35°C to + 45°C

IP rating

IP 54

Appearance

Dimensions: L1000 x W18.4 x H10 mm

Max Length available: 3100 mm

Diffuser: clear

Accessories

Spring steel clips / magnetic tape

Wire exit

Linear & 90°x 3ways out

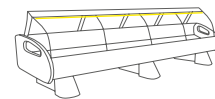
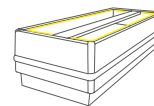
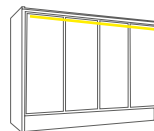

NIZZA LINEAR

PMMA LED cooler linear lighting fixture

The co-extruded PMMA lighting fixture is designed for shelf and refrigeration display lighting.

Food display versions are available.

Different configurations available upon request.

Specifications / data per meter

Electrical

Power: 9.6W

Input voltage: 12V / 24V DC

Current: 500mA

LED

Type: 2835

Q'ty: 140 pcs

CCT: 2700K- 6500K

CRI >80 Ra

Light Output

Beam angle: 120°

Efficiency: 80-90 Lm/W

Lumen: 820 Lm

Food Display Versions

Meat: CCT-Pink

Fish: CCT- 10000K

Vegetable&Fruit: CRI >97 Ra

Working temperature

-25°C/ -35°C to + 45°C

IP rating

IP 54

Appearance

Dimensions: L1000 x W11 x H12 mm

Max Length available: 3100 mm

Diffuser: milky

Accessories

Spring steel clips / magnetic tape

Wire exit

Linear & 90° x 3 ways out

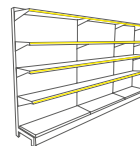
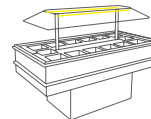
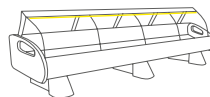
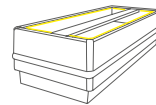
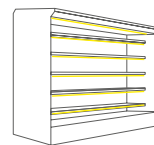

MONZA LINEAR

PMMA LED cooler linear lighting fixture

A special optical diffuser makes the LED dots invisible, creating a linear effect similar to that of fluorescent tubes. Food display versions are available. Different configurations available upon request.



Specifications / data per meter

Electrical

Power: 9.6W

Input voltage: 12V / 24V DC

LED

Type: 2835

Q'ty: 140 pcs

CCT: 2700K- 6500K

CRI >80 Ra

Light Output

Beam angle: 120°

Efficiency: 50-60 Lm/W

Lumen: 530 Lm

Food Display Versions

Meat: CCT-Pink

Fish: CCT- 10000K

Vegetable&Fruit: CRI >97 Ra

Working temperature

-25°C/ -35°C to + 45°C

IP rating

IP 54

Appearance

Dimensions: L1000 x W11x H14 mm

Max Length available: 3100 mm

Diffuser: milky white

Accessories

Spring steel clips / magnetic tape

Wire exit

Linear + 90° x 3 ways out

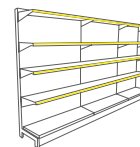
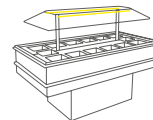
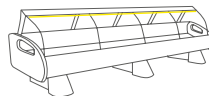
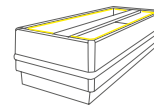
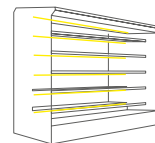

MILANO SLIM

Aluminium LED cooler lighting fixture

Milano Slim is dedicated to wall type vertical freezers & chillers.
The special lens design creates an even light distribution up to 50cm to both sides.
Meat display versions are available.
Different configurations available upon request.

Specifications / data per meter

Electrical

Power: 20W
Input voltage: 24V DC

LED

Type: 3535
Q'ty: 19 pcs
CCT: 3000K- 6500K
CRI >80 Ra

Light Output

Beam angle: 175°
Efficiency: 73 Lm/W
Lumen: 1450 Lm

Food Display Versions

Meat: CCT-Pink

Working temperature

-25°C/ -35°C to + 45°C

IP rating

IP 54

Appearance

Dimensions: L1000 x W27.8 x H22.8 mm
Max Length available: 2500 mm
Diffuser: clear

Accessories

Screws / magnets

Wire exit

Linear+90°down

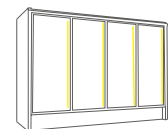

MILANO SLIM CORNER

Aluminium LED cooler lighting fixture

Milano Slim Corner is dedicated to wall type vertical freezers & chillers. The special lens design creates an even light distribution up to 50cm to one side. Each freezer requires 2 pcs. Meat display versions are available. Different configurations available upon request.

Specifications / data per meter

Electrical

Power: 12W

Input voltage: 24V DC

LED

Type: 3535

Q'ty: 12 pcs

CCT: 3000K- 6500K

CRI >80 Ra

Light Output

Beam angle: 85°

Efficiency: 78 Lm/W

Lumen: 936 Lm

Food Display Versions

Meat: CCT-Pink

Working temperature

-25°C/ -35°C to + 45°C

IP rating

IP 54

Appearance

Dimensions: L 1000 x W27.8 x H22.8 mm

Max Length available: 2500 mm

Diffuser: clear

Accessories

Screws / magnets

Wire exit

Linear + 90° down

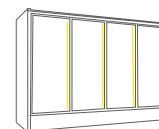

SIENA

PMMA LED cooler lighting fixture

Siena is designed for shelf and refrigeration display lighting.
Mounting is easy using metal clips or magnets.
Food display versions are available.
Different configurations available upon request.

Specifications / data per meter

Electrical

Power: 9.6W/14.4W(HB)
Input voltage: 12V/24V DC

LED

Type: 2835
Q'ty: 120 pcs
CCT: 2700K- 6500K
CRI >80 Ra

Light Output

Beam angle: 110°
Efficiency: 110-110 Lm/W
Lumen: 1020 Lm / 1530 Lm (HB)

Food Display Versions

Meat: CCT-Pink
Fish: CCT- 10000K
Vegetable&Fruit: CRI >97 Ra

Working temperature

-25°C/ -35°C to + 45°C

IP rating

IP 54

Appearance

Dimensions: L1000 x W17 x H8.7 mm
Max Length available: 3100 mm
Diffuser: clear / frosted

Accessories

Spring steel clips /magnets

Wire exit

Linear + 90°down

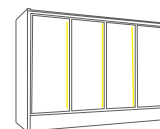

MANTUA

PMMA LED cooler lighting fixture

Mantua is designed for refrigeration lighting applications as an alternative to T5 tube light installations.
Food display versions are available.
Different configurations available upon request.

Specifications / data per meter

Electrical

Power: 9.6W/14.4W(HB)
Input voltage: 12V/24V DC

LED

Type: 2835
Q'ty: 120 pcs
CCT: 2700K- 6500K
CRI >80 Ra

Light Output

Beam angle: 110°
Efficiency: 110-110 Lm/W
Lumen: 1020 Lm / 1530 Lm (HB)

Food Display Versions

Meat: CCT-Pink
Fish: CCT- 10000K
Vegetable&Fruit: CRI >97 Ra

Working temperature

-25°C/ -35°C to + 45°C

IP rating

IP 54

Appearance

Dimensions: Φ16mm
Max Length available: 3100 mm
Diffuser: clear / frosted

Accessories

Spring steel clips/ adjustable clip

Wire exit

Linear + 90°x 3 ways out

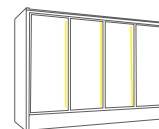

SHELF LIGHTING



SHELF TAG LIGHT

The specially designed Shelf Tag Light illuminates the price tags through a dedicated extruded light guide. Plus it lights 30° down to a lower shelf compartment, providing an evenly spread light for a shelf up to 50 cm high and 50 cm deep.

Different configurations available upon request.



Specifications / data per meter

Electrical

Power: 22W

Input voltage: 24V DC

LED

Type: 2835

Q'ty: 120 pcs

CCT: 2700K- 6500K

CRI >80 Ra

Light Output

Beam angle: 30° front side up & 30° back side down

Efficiency: 100 Lm/W

Lumen: 2200 Lm

Appearance

Material: anodized aluminium, PMMA, PVC

Max Length available: 5000 mm

Diffuser over light guide: clear

Versions

Standard (using a double-sided tape) / for Scantech® shelves / for Tegometall® shelves / for AHT® shelves.

Wire exit

Omni-directional possible, secured by a strain relief (applies to lighting fixture norms)

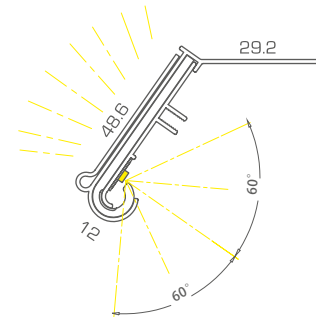

VERSIONS



Standard

Universal type to be taped onto the front top of the shelf



Scantech®

Special made for Scantech® shelves



Tegometall®

Special made for Tegometall® shelves

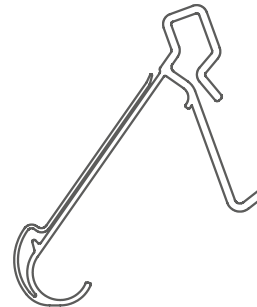

AHT®

Special made for AHT® shelves

MONACO

Our smallest lighting fixture ever, just 5mm x 7mm!
 Hundreds of thousands sold to the European display industry.
 Monaco is designed for display, cabinet and undercabinet applications.
 Different configurations available upon request.

Specifications / data per meter

Electrical

Power: 9.6W

Input voltage: 12V/24V DC

LED

Type: 2835

Q'ty: 120 pcs

CCT: 2700K- 6500K

CRI >80 Ra

Light Output

Beam angle: 120°

Efficiency: 80 Lm/W

Lumen: 750 Lm

Appearance

Material: PMMA

Dimensions: L1000 x W7 x H5 mm

Max Length available: 2500 mm

Diffuser: clear / frosted / milky

Mounting

Surface

Accessories

Spring steel clips

Wire exit

Linear+90°down



ALU MONACO semi-linear

Another ultra small lighting fixture, just 8mm x 10mm!

This one is designed for ceiling, wall, cabinet and undercabinet applications.

Semi-linear, means the LED dots are slightly visible, Alu Monaco does not provide a completely linear light, as our ROMA.

Different configurations available upon request.

Specifications / data per meter

Electrical

Power: 9.6W

Input voltage: 12V/24V DC

LED

Type: 2835

Q'ty: 140 pcs

CCT: 2700K- 6500K

CRI >80 Ra

Light Output

Beam angle: 90°

Efficiency: 80 Lm/W

Lumen: 750 Lm

Appearance

Material: anodized aluminium, PMMA

Dimensions: L1000 x W8 x H10 mm

Max Length available: 2500 mm

Diffuser: clear / frosted / milky

Mounting

Surface / recessed

Accessories

Spring steel clips

Wire exit

Linear + 90°down



ALU MONACO SLIM

An ultra slim lighting fixture, just 6mm x 8mm.
Alu Monaco Slim is designed for ceiling, wall, cabinet and undercabinet applications.
One of the smallest LED lighting fixtures in the world.
Different configurations available upon request.

Specifications / data per meter

Electrical

Power: 9.6W
Input voltage: 12V/24V DC

LED

Type: 2216
Q'ty: 120 pcs
CCT: 2700K- 6500K
CRI >80 Ra

Light Output

Beam angle: 120°
Efficiency: 80 Lm/W
Lumen: 750 Lm

Appearance

Material: anodized aluminium, PMMA
Dimensions: L1000 x W8 x H6 mm
Max Length available: 2500 mm
Diffuser: frosted / milky

Mounting

Surface / recessed

Accessories

Spring steel clips

Wire exit

Linear + 90° down

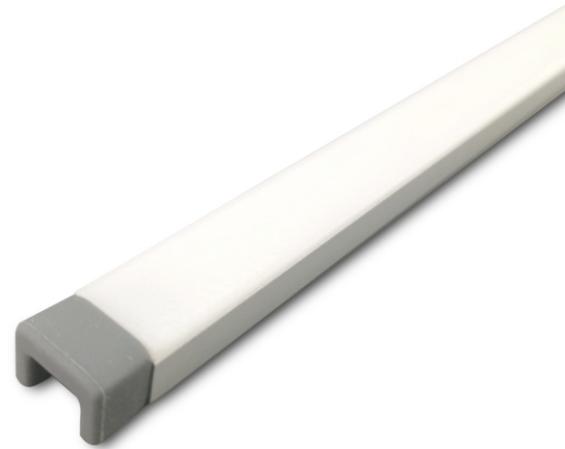

ROMA

The smallest linear fixture in the world, just in 10mm x10mm.
Our special lenticular diffuser creates a truly linear light without any visible LED dots.
A perfect choice, if you are looking for a small yet linear light source up to 2500mm

Specifications / data per meter

Electrical

Power: 9.6W
Input voltage: 24V DC

LED

Type: 2835
Q'ty: 140 pcs
CCT: 2700K- 6500K
CRI >80 Ra

Light Output

Beam angle: 140°
Efficiency: 70 Lm/W
Lumen: 670 Lm

Appearance

Material: anodized aluminium, PMMA
Dimensions: L1000 x W10 x H10 mm
Max Length available: 3100 mm
Diffuser: milky

Mounting

Surface

Accessories

Spring steel clips / adhesive tape

Wire exit

Linear + 90°down



SLIMLINE SM

Slimline SM is designed for shelf and refrigeration display lighting.
Mounting is easy using metal clips and magnets.
Our standard fixture for most lighting applications.
Food display versions are available.
Different configurations available upon request.

Specifications / data per meter

Electrical

Power: 9.6W
Input voltage: 12V/24V DC

LED

Type: 2835
Q'ty: 120 pcs
CCT: 2700K- 6500K
CRI >80 Ra

Light Output

Beam angle: 120°
Efficiency: 90-100 Lm/W
Lumen: 950 Lm (clear), 780 Lm (milky)

Food Display Versions

Meat: CCT-Pink
Fish: CCT- 10000K
Vegetable&Fruit: CRI >97 Ra

Appearance

Material: anodized aluminium, PMMA
Dimensions: L1000 x W17 x H8.7mm
Max Length available: 2500 mm
Diffuser: clear / frosted / milky

Mounting

Surface

Wire exit

Linear + 90°down



SLIMLINE RM

Slimline RM allows a recessed, flush mounting.
It is designed for display and cabinet lighting applications.
Food display versions are available.
Different configurations available upon request.

Specifications / data per meter

Electrical

Power: 9.6W
Input voltage: 12V/24V DC

LED

Type: 2835
Q'ty: 120 pcs
CCT: 2700K- 6500K
CRI >80 Ra

Light Output

Beam angle: 120°
Efficiency: 90-100 Lm/W
Lumen: 950 Lm (clear), 780 Lm (milky)

Food Display Versions

Meat: CCT-Pink
Fish: CCT- 10000K
Vegetable&Fruit: CRI >97 Ra

Appearance

Material: anodized aluminium, PMMA
Dimensions: L1000 x W17 x H8.7mm
Max Length available: 2500 mm
Diffuser: clear / frosted / milky

Mounting

Recessed

Wire exit

Linear + 90°down



LAS VEGAS

LAS VEGAS is a fixture which offers 5 different light beam angles (20°), (45°), (60°), (75°), (90°), This focuses the light and creates various wallwasher effects.

Specifications / data per meter

Electrical

Power: 14.4W

Input voltage: 12V/24V DC

LED

Type: 2835

Q'ty: 120 pcs

CCT: 2700K- 6500K

CRI >80 Ra

Light Output

Beam angle: Adjustable (20°, 45°, 60°, 75°, 90°)

Efficiency: 80Lm/W

Lumen: 1150 Lm (clear)

Appearance

Material: anodized aluminium, PMMA

Dimensions: L1000 x W15.5 x H18 mm

Max Length available: 2500 mm

Diffuser: clear

Mounting

Surface

Accessories

spring steel clips / magnetic tape

Wire exit

Linear + 90°down



MONZA LINEAR

PMMA LED shelf linear lighting fixture

A special optical diffuser makes the LED dots invisible, creating a linear effect similar to that of fluorescent tubes.

Food display versions are available.

Different configurations available upon request.

Specifications / data per meter

Electrical

Power: 9.6W

Input voltage: 12V / 24V DC

LED

Type: 2835

Q'ty: 140 pcs

CCT: 2700K- 6500K

CRI >80 Ra

Light Output

Beam angle: 120°

Efficiency: 50-60 Lm/W

Lumen: 530 Lm

Food Display Versions

Meat: CCT-Pink

Fish: CCT- 10000K

Vegetable&Fruit: CRI >97 Ra

Appearance

Dimensions: L1000 x W11x H14 mm

Max Length available: 3100 mm

Diffuser: milky white

Accessories

Spring steel clips / magnetic tape

Wire exit

Linear & 90°x 3 ways out



NIZZA LINEAR

PMMA LED shelf linear lighting fixture

The co-extruded PMMA lighting fixture is designed for shelf and refrigeration display lighting.

Food display versions are available.

Different configurations available upon request.

Specifications / data per meter

Electrical

Power: 9.6W

Input voltage: 12V / 24V DC

LED

Type: 2835

Q'ty: 140 pcs

CCT: 2700K- 6500K

CRI >80 Ra

Light Output

Beam angle: 120°

Efficiency: 80-90 Lm/W

Lumen: 820 Lm

Food Display Versions

Meat: CCT-Pink

Fish: CCT- 10000K

Vegetable&Fruit: CRI >90 Ra

Appearance

Dimensions: L1000 x W11 x H12 mm

Max Length available: 3100 mm

Diffuser: milky

Accessories

Spring steel clips / magnetic tape

Wire exit

Linear & 90° x 3 ways out



MEMPHIS

Memphis is designed as a solid shelf lighting fixture.
Several mounting options apply.
Fresh food display versions and different configurations are available upon request.

Specifications / data per meter

Electrical

Power: 9.6W
Input voltage: 12V/24V DC

LED

Q'ty: 120 pcs
CCT: 2700K- 6500K
CRI >80 Ra

Light Output

Beam angle: 120°
Efficiency: 90-130 Lm/W
Lumen: Lumen: 1280 Lm (clear), 720 Lm (milky)

Appearance

Material: anodized aluminium, PMMA
Dimensions: L1000 x W17 x H17.8 mm
Max Length available: 2514 mm
Diffuser: clear / frosted / milky

Mounting

Surface

Accessories

Spring steel clips / magnetic tape

Wire exit

Linear + 90° down

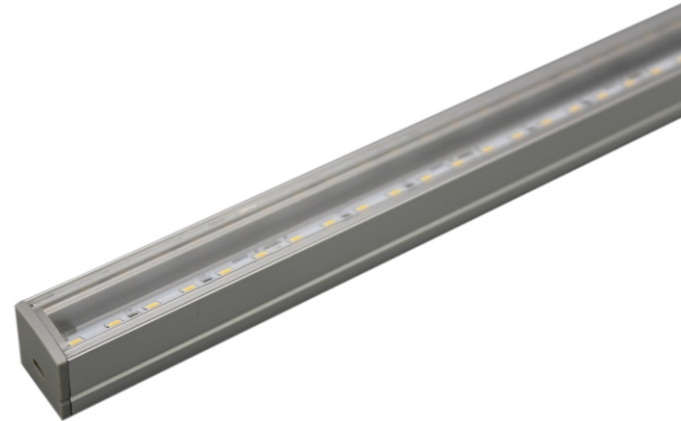

MIAMI SM

Miami SM is designed as a surface mounting redirecting shelf lighting
An ideal fixture for shelf lighting from the front.
Fresh food display versions and different configurations are
available upon request.

Specifications / data per meter

Electrical

Power: 11.5W
Input voltage: 24V DC

LED

Type: 2216
Q'ty: 210 pcs
CCT: 2700K- 6500K
CRI >90 Ra

Light Output

Beam Angle: 90°
Efficiency: 55Lm/W
Lumen: 630 Lm (milky)

Appearance

Material: anodized aluminium, PC
Dimensions: L1000 x W22 x H12.5 mm
Max Length available: 2000 mm
Diffuser: milky

Mounting

Surface

Accessories

Screwable endcaps / spring steel clips / magnetic tape

Wire exit

Linear + 90°down

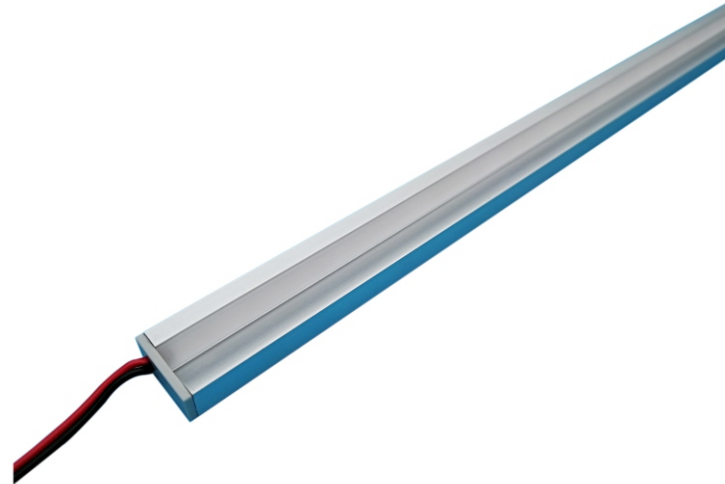

MIAMI RM

Miami RM is designed as a recessed redirecting shelf lighting fixture.
An ideal fixture for shelf lighting from the front.
Fresh food display versions and different configurations are available upon request.

Specifications / data per meter

Electrical

Power: 11.5W
Input voltage: 24V DC

LED

Type: 2216
Q'ty: 210 pcs
CCT: 2700K- 6500K
CRI >90 Ra

Light Output

Beam Angle: 90°
Efficiency: 55Lm/W
Lumen: 630 Lm (milky)

Appearance

Material: anodized aluminium, PC
Dimensions: L1000 x W22 x H12.5 mm
Max Length available: 2000 mm
Diffuser: milky

Mounting

Recessed

Accessories

Screwable endcaps / spring steel clips / magnetic tape

Wire exit

Linear + 90°down



TORINO

Torino is designed for shelf lighting applications as an alternative to T5 and T8 tube light installations.

The fixture can be easily mounted -45° to $+45^{\circ}$ in 15° steps.

Fresh food display versions and different configurations are available upon request.

Specifications / data per meter

Electrical

Power: 9.6W

Input voltage: 12V/24V DC

LED

Type: 2835

Q'ty: 120 pcs

CCT: 2700K- 6500K

CRI >80 Ra

Light Output

Beam angle: 120°

Efficiency: 90-100 Lm/W

Lumen: 1280 Lm (clear), 720 Lm (milky)

Appearance

Material: anodized aluminium, PMMA

Dimensions: L1000 x Dia 16 mm

Max Length available: 2500 mm

Diffuser: clear / frosted / milky

Mounting

Surface

Accessories

Spring steel clips

Wire exit

Linear + 90° down



ALU CANNES linear

A special optical diffuser makes the LED dots nearly invisible.
Creating a linear effect similar to that of fluorescent tubes.
Different configurations available upon request.

Specifications / data per meter

Electrical

Power: 9.6W

Input voltage: 12V/24V DC

LED

Type: 2835

Q'ty: 140 pcs

CCT: 2700K- 6500K

CRI >80 Ra

Light Output

Beam angle: 110°

Efficiency: 50 Lm/W

Lumen: 480 Lm

Appearance

Material: anodized aluminium, PMMA

Dimensions: L1000 x W10 x H10 mm

Max Length available: 2500 mm

Diffuser: milky

Mounting

Surface (especially in corners)

Accessories

Spring steel clips

Wire exit

Linear



CANNES

PMMA LED shelf linear lighting fixture

The quadrant lighting fixture
can be adapted to any corner elegantly.
Food display versions are available.
Different configurations available upon request.

Specifications / data per meter

Electrical

Power: 9.6W / 14.4W (HB)
Input voltage: 12V / 24V DC

LED

Type: 2835
Q'ty: 120 pcs
CCT: 2700K- 6500K
CRI >80 Ra

Light Output

Beam angle: 120°
Efficiency: 110-120 Lm/W
Lumen: 1050 Lm (Clear) / 960 Lm (frosted)

Food Display Versions

Meat: CCT-Pink
Fish: CCT- 10000K
Vegetable&Fruit: CRI >97 Ra

Appearance

Dimensions: L1000 x W10 x H10 mm
Max Length available: 3100 mm
Diffuser: clear / frosted

Accessories

Spring steel clips / magnetic tape

Wire exit

Linear + 90° down x 3 ways out



ALINA

Flexible Shelf Light

Fully flexible lighting fixture, designed for shaped displays, cabinet and undercabinet applications.

Different color options (black, white, custom colors with MOQ).

Different configurations available upon request.

Specifications / data per meter

Electrical

Power: 9.6W

Input voltage: 12V / 24V DC

LED

Type: 2835

Q'ty: 120 pcs

CCT: 2700K- 6500K

CRI >80 Ra

Light Output

Beam angle: 120°

Efficiency: 75 Lm/W

Lumen: 700 Lm

Appearance

Material: PVC

Dimensions: L1000 x W14 x H7.9 mm

Max Length available: 5000 mm

Diffuser: clear/milky

Accessories

Spring steel clip/ adhesive tape/ magnetic tape

Wire exit

Linear



Dimmable

LONG ISLAND

Long Island is the slimmest lighting fixture in the world, only 3mm thick!
A flexible lighting fixture using SideLEDs.
An ideal solution for slim shelf lighting, trim lighting and shape lighting.
Different configurations available upon request.

Specifications / data per meter

Electrical

Power: 9.6W

Input voltage: 24V DC

LED

Q'ty: 120 pcs

CCT: 8000K

CRI >80 Ra

Light Output

Beam angle: 140°

Efficiency: 75 Lm/W

Lumen: 700 Lm

Appearance

Dimensions: L1000 x W10.3 x H3.0 mm

Max Length available: 2500 mm

Diffuser: clear

Accessories

adhesive tape/ magnetic tape

Wire exit

Linear



Power Track System



Power Track
Length: Customized (Max. 2m)
Color: Black
Mounting: Magnetic Strip/Adhesive Tape/Plastic Clip



Power Track
Length: Customized (Max. 2m)
Color: Silver
Mounting: Magnetic Strip/Adhesive Tape/Plastic Clip



Power Track
Length: Customized (Max. 2m)
Color: White
Mounting: Magnetic Strip/Adhesive Tape/Plastic Clip

IP54 Power Track

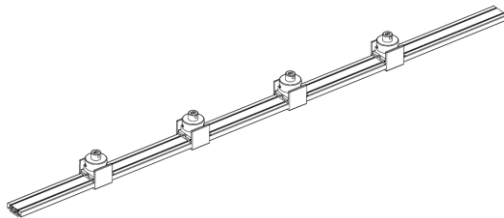

IP54 Power Track
Length: Customized, (Max. 2m)
Color: Grey
Mounting: Magnetic Strip/Adhesive Tape/Plastic Clip with screws

IP 54 Connector System



Connecting Cable
Art. No: C582NGCM11
Male Plug + Open ends with tin
Usage: wire for lighting fixture



Connecting Cable
Art. No: C582NGCF11
Female Plug + Open ends with ferrules
Usage: wire for power supply



Extension Cable
Art. No: C582NGE001
Female Plug + Male Plug
Usage: wire for extension



Y-Splitter, Connecting
Art. No: C582NGYF01
2 female plugs + open end with ferrules
Usage: wire for power supply



Y-Splitter, Extension
Art. No: C582NGYM11
2 female plugs + 1 male plug
Usage: wire for extension



7x Distribution Box, Connecting
Art. No: C582NG7F01
Distribution box + open ends with ferrules
Usage: distribution for power supply



7x Distribution Box, Extension
Art. No: C582NG7M11
Distribution box + male plug
Usage: for star type wiring

LED Mini Connector System



Connecting Cable
Art. No: MINIM002-UL
Male Plug + Open ends with tin
Usage: wire for lighting fixture



Connecting Cable
Art. No: MINIF001-UL
Female Plug + Open ends with ferrules
Usage: wire for power supply



Extension Cable
Art. No: MINI003-UL
Female Plug + Male Plug
Usage: wire for extension



3x Distribution Box, Connecting
Art. No: MINIDIS3-UL
Distribution box + open ends with ferrules
Usage: distribution for power supply



4x Distribution Box, Connecting
Art. No: MINIDIS4-UL
Distribution box + open ends with ferrules
Usage: distribution for power supply



6x Distribution Box, Connecting
Art. No: MINIDIS6-UL
Distribution box + open ends with ferrules
Usage: distribution for power supply



10x Distribution Box, Connecting
Art. No: MINIDIS10-UL
Distribution box + open ends with ferrules
Usage: distribution for power supply



3x Distribution Box, Extension
Art. No: MINIDIS3-M-UL
Distribution box + male plug
Usage: for star type wiring



4x Distribution Box, Extension
Art. No: MINIDIS4-M-UL
Distribution box + male plug
Usage: for star type wiring



6x Distribution Box, Extension
Art. No: MINIDIS6-M-UL
Distribution box + male plug
Usage: for star type wiring



10x Distribution Box, extension
Art. No: MINIDIS10-M-UL
Distribution box + male plug
Usage: for star type wiring

XHP Connector System



Connecting Cable
Art. No: XHPM002-UL
Male Plug + Open ends with tin
Usage: wire for lighting fixture



Connecting Cable
Art. No: XHPF001-UL
Female Plug + Open ends with ferrules
Usage: wire for power supply



Extension Cable
Art. No: XHP003-UL
Female Plug + Male Plug
Usage: wire for extension



10x Distribution Box, Connecting
Art. No: WF0070-UL
Distribution box + Open ends with ferrules
Usage: distribution for power supply



10x Distribution Box, Extension
Art. No: WF0070-C-UL
Distribution box + male plug
Usage: for star type wiring

DC Jack Cable System



Connecting Cable
Art. No: DC01-UL
Male Plug + Open ends with tin
Usage: wire for lighting fixture



Connecting Cable
Art. No: DC02-UL
Female Plug + Open ends with ferrules
Usage: wire for power supply



Extension Cable
Art. No: DC-M/F-UL
Female Plug + Male Plug
Usage: wire for extension



Y-Splitter, Extension
Art. No: C582NGYF01
4 male plugs + 1 female plug
Usage: for star type wiring

Adapting Cable System



Adapting Cable
Art. No: WPIP54-M-DCM-UL
IP54 male + DC jack male
Usage: wire for adapting



Adapting Cable
Art. No: WPIP54-F-DCF-UL
IP54 female + DC jack female
Usage: wire for adapting



Adapting Cable
Art. No: MINIMDCM004-UL
LED mini plug male + DC jack male
Usage: wire for adapting



Adapting Cable
Art. No: MINIFDCF007-UL
LED mini plug female + DC jack female
Usage: wire for adapting



Adapting Cable
Art. No: XHPMDCM006-UL
XHP male + DC jack male
Usage: wire for adapting



Adapting Cable
Art. No: WPIP54-F-DCF-UL
XHP female + DC jack female
Usage: wire for adapting

LED PROFILE

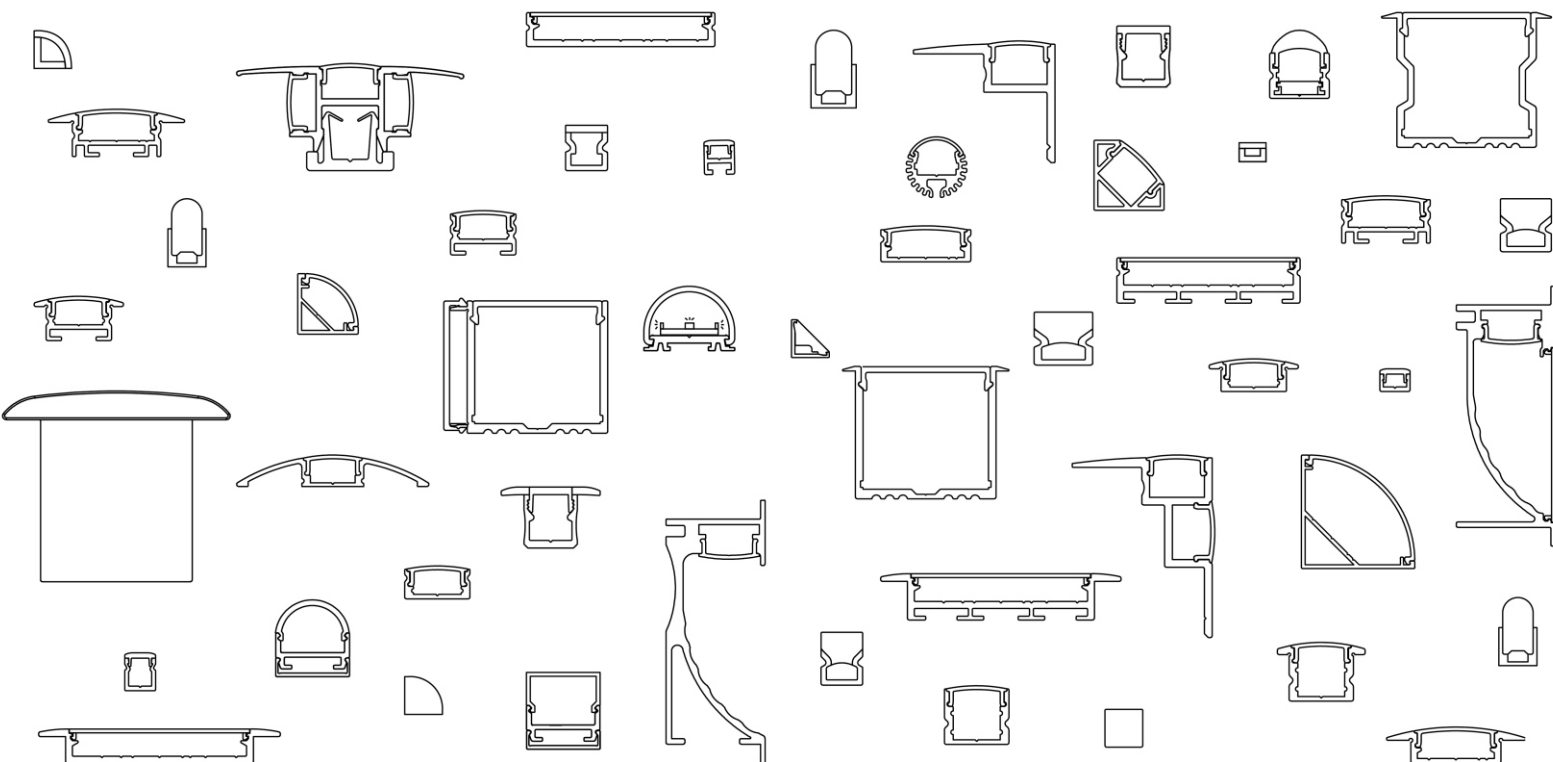

TOPLINE ALU 6

SPECIFICATIONS

Model No. PA20AA4019

Material: anodized aluminium

Width for LED strip: 6 mm

Dimensions: L2500 x W8 x H6 mm

Mounting: surface / recessed



ACCESSORIES

End Caps	EC40PC4041 (PC)
	EC42SI4000 (silicone)
	EC40SI4054 (90° silicone)
Covers	CP10PM4C45 (milky)
	CP10PM4F40 (frosted)
Mounting	MD30SSU109 (clip)

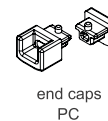

end caps
PC

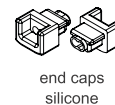

end caps
silicone



end cap
90° silicone



covers



clip

TOPLINE ALU 7_{semi linear}

SPECIFICATIONS

Model No. PA20AA4000

Material: anodized aluminium

Width for LED strip: 6 mm

Dimensions: L2500 x W8 x H10 mm

Mounting: surface / recessed

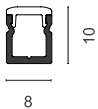

ACCESSORIES

End Caps	EC42SI4001 (silicone)
----------	-----------------------

Covers	CP10PM4C45 (clear) CP10PM4F40 (frosted)
--------	--

Mounting	MD30SSU109
----------	------------

Semi linear with milky cover.

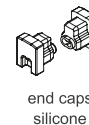

INLINE ALU 8

SPECIFICATIONS

Model No. PA21AA6003
 Material: anodized aluminium
 Width for LED strip: 12.4 mm
 Dimensions: L2500 x W23.2 x H8.7 mm
 Mounting: recessed

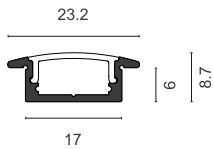

ACCESSORIES

End Caps	EC41PC6009
Covers	CP11PM5C05 (clear) CP11PM5F07 (frosted) CP11PM5M06 (milky)

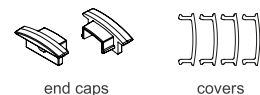

TOPLINE ALU 8

SPECIFICATIONS

Model No. PA21AA4004
Material: anodized aluminium
Width for LED strip: 12.4 mm
Mounting: surface
Dimensions: L2500 x W17 x H8.7 mm

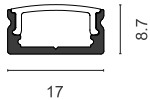

ACCESSORIES

End Caps	EC41PC4010
Covers	CP11PM5C05 (clear) CP11PM5F07 (frosted) CP11PM5M06 (milky)
Mounting	MD31SSU101 (clip)

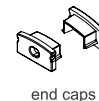

end caps



covers



clip

INLINE ALU 11

SPECIFICATIONS

Model No. PA21AA7W30

Material: anodized aluminium

Width for LED strip: 12.4 mm

Mounting: recessed

Dimensions: L2500 x W23.3 x H11.7 mm

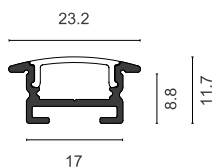

ACCESSORIES

End Caps	EC41PC6009
Covers	CP11PM5C05 (clear) CP11PM5F07 (frosted) CP11PM5M06 (milky)
Mounting	MD41NY0001 (invisible clip) MD41NY0002 (spring clip - recessed mount) MD41NY0003 (clip with rope - surface mount) MD32MA7000 (magnet)
Connectors	MD41NY2900 (90° connector) MD41NY2800 (180° connector) MD41NY2T00 (T-connector) MD41NY2X00 (X-connector)

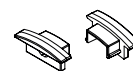

end caps



covers



invisible clip



spring clip
recessed mount

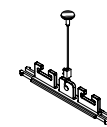

clip with rope
surface mount



magnet



90° connector



180° connector



T-connector



X-connector

TOPLINE ALU 11

SPECIFICATIONS

Model No. PA21AA7031

Material: anodized aluminium

Width for LED strip: 12.4 mm

Dimensions: L2500 x W17 x H11.7 mm

Mounting: surface

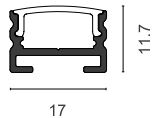

ACCESSORIES

End Caps	EC41PC6009
Covers	CP11PM5C05 (clear) CP11PM5F07 (frosted) CP11PM5M06 (milky)
Mounting	MD41NY0001 (invisible clip) MD41NY0002 (spring clip - recessed mount) MD41NY0003 (clip with rope - surface mount) MD32MA7000 (magnet)
Connectors	MD41NY2900 (90° connector) MD41NY2800 (180° connector) MD41NY2T00 (T-connector) MD41NY2X00 (X-connector)



end caps



covers



invisible clip



spring clip
recessed mount

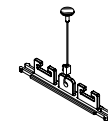

clip with rope
surface mount



magnet



90° connector



180° connector



T-connector



X-connector

INLINE ALU 10

SPECIFICATIONS

Model No. PA21AA6013

Material: anodized aluminium

Width for LED strip: 20 mm

Dimensions: L2500 x W36 x H9.5 mm

Mounting: recessed

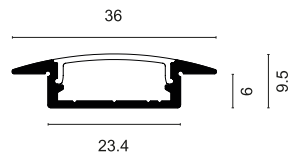

ACCESSORIES

End Caps	EC41PC6038
Covers	CP11PM5C14 (clear)
	CP11PM5F16 (frosted)
	CP11PM5M15 (milky)

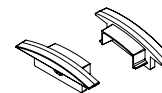

end caps



covers

TOPLINE ALU 10

SPECIFICATIONS

Model No. PA21AA4008
Material: anodized aluminium
Width for LED strip: 20 mm
Dimensions: L2500 x W23.4 x H9.5 mm
Mounting: surface

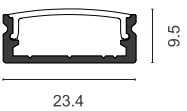

ACCESSORIES

End Caps	EC41PC4008
Covers	CP11PM5C14 (clear) CP11PM5F16 (frosted) CP11PM5M15 (milky)
Mounting	MD31SSU104 (clip)

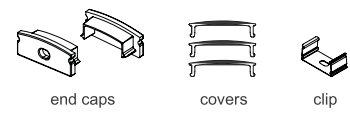

INLINE ALU 12

SPECIFICATIONS

Model No. PA21AA7W32

Material: anodized aluminium

Width for LED strip: 20 mm

Dimensions: L2500 x W36 x 12.5 mm

Mounting: recessed

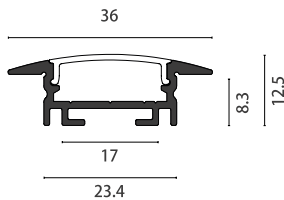

ACCESSORIES

End Caps	EC41PC6009
Covers	CP11PM5C14 (clear) CP11PM5F16 (frosted) CP11PM5M15 (milky)
Mounting	MD41NY0001 (invisible clip) MD41NY0002 (spring clip - recessed mount) MD41NY0003 (clip with rope - surface mount) MD32MA7000 (magnet)
Connectors	MD41NY2900 (90° connector) MD41NY2800 (180° connector) MD41NY2T00 (T-connector) MD41NY2X00 (X-connector)

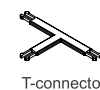
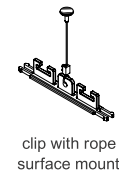
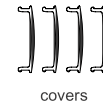
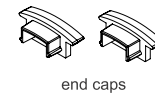

TOPLINE ALU 12

SPECIFICATIONS

Model No. PA21AA7031

Material: anodized aluminium

Width for LED strip: 20 mm

Dimensions: L2500 x W23.4 x H12.5 mm

Mounting: surface

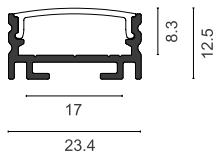

ACCESSORIES

End Caps	EC41PC4008
Covers	CP11PM5C14 (clear) CP11PM5F16 (frosted) CP11PM5M15 (milky)
Mounting	MD41NY0001 (invisible clip) MD41NY0002 (spring clip - recessed mount) MD41NY0003 (clip with rope - surface mount) MD32MA7000 (magnet)
Connectors	MD41NY2900 (90° connector) MD41NY2800 (180° connector) MD41NY2T00 (T-connector) MD41NY2X00 (X-connector)

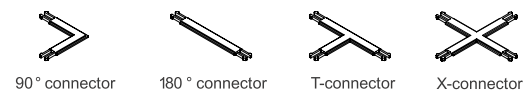
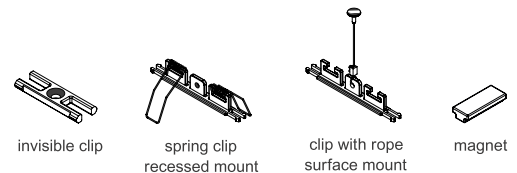
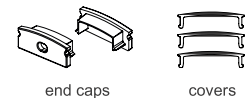

INLINE ALU 15 semi linear

SPECIFICATIONS

Model No. PA21AA6005

Material: anodized aluminium

Width for LED strip: 12.4 mm

Dimensions: L2500 x W23.2 x H15.5 mm

Mounting: recessed

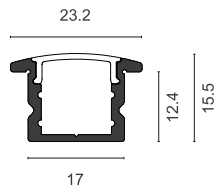

ACCESSORIES

End Caps	EC41PC6011
Covers	CP11PM5C05 (clear)
	CP11PM5F07 (frosted)
	CP11PM5M06 (milky)

Semi linear with milky cover.

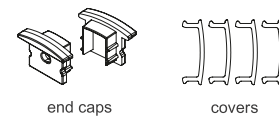

TOPLINE ALU 15 semi linear

SPECIFICATIONS

Model No. PA21AA4006
Material: anodized aluminium
Width for LED strip: 12.4 mm
Dimensions: L2500 x W17 x H15.5 mm
Mounting: surface

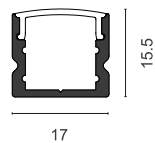

ACCESSORIES

End Caps	EC41PC4012
Covers	CP11PM5C05 (clear) CP11PM5F07 (frosted) CP11PM5M06 (milky)
Mounting	MD31SSU101 (clip)

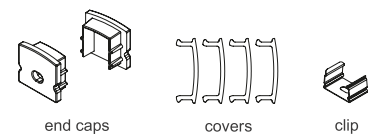

Semi linear with milky cover.

TOPLINE ALU 21 semi-linear

SPECIFICATIONS

Model No. PA70AA4010

Material: anodized aluminium



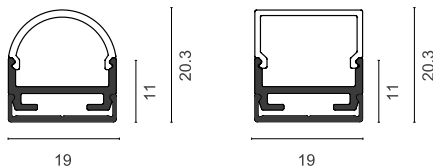

Width for LED strip: 16.9 mm

Dimensions: L2500 x W19 x H20.3 mm

Mounting: surface

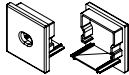
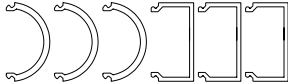
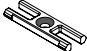

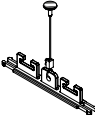
ACCESSORIES

End Caps	EC50PC4R00 (round) EC50PC4E00 (rectangular)			
Covers (round / rectangular)	CP50PM3C10 / CP50PM5C12 (clear) CP50PM3F27 / CP50PM5F28 (frosted) CP50PM3M11 / CP50PM5M13 (milky)	end caps round	end caps rectangular	covers
Mounting	MD41NY0001 (invisible clip) MD41NY0002 (spring clip - recessed mount) MD41NY0003 (clip with rope - surface mount) MD32MA7000 (magnet)			
Connectors	MD41NY2900 (90° connector) MD41NY2800 (180° connector) MD41NY2T00 (T-connector) MD41NY2X00 (X-connector)		invisible clip	spring clip recessed mount
		90° connector	180° connector	T-connector
				X-connector

Semi-linear with milky cover.

OPTICLINE ALU 12

SPECIFICATIONS

Model No. PA21AA4010
 Material: anodized aluminium
 Width for LED strip: 10.8 mm
 Dimensions: L2500 x W15.5 x H18 mm
 Mounting: surface
 Beam angle: 20°, 45°, 60°, 75°, 90°

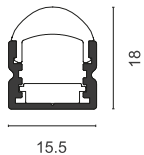

ACCESSORIES

End Caps	EC41PC4025
Covers	CP10PM4C22 (clear)
Mounting	MD31SSU106 (clip)
Adjusting Rail	PA20AA2021

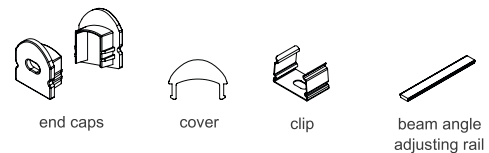

One profile for multiple lighting beam angles:

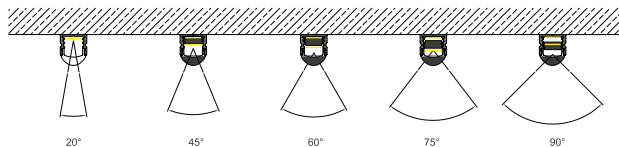

The OPTICline Alu 12 profile offers an asymmetric inserting rail that can be placed in 2 different positions or left out. Combined with the lens type cover it offers 5 different light beam angles (depending on the LED size and height, using LUXx reference LED strips: 20° to 90°). This focuses the light and creates various wallwasher effects.

TUBELINE ALU 16

SPECIFICATIONS

Model No. PA21AA0009

Material: anodized aluminium

Width for LED strip: 10.2 mm

Dimensions: L2500 x ø16 mm

Mounting: rotatable in 15° steps $\pm 45^\circ$ in both directions by inserting the mounting clips in different heat sink fin positions

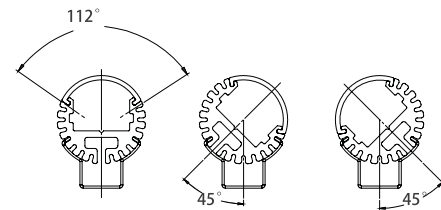

adjustable $\pm 45^\circ$ in 15° steps

ACCESSORIES

End Caps	EC41PC0020
Covers	CP11PM3C17 (clear) CP11PM3F19 (frosted) CP11PM3M18 (milky)
Mounting	MD30SS0100 (clip) MD30SS0118 (adjustable plastic clip)

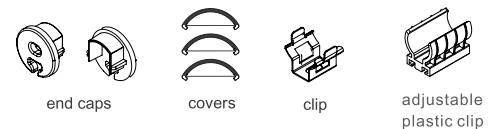

MULTILINE ALU 16 semi linear

SPECIFICATIONS

Model No. PA20AA4003

Material: anodized aluminium

Width for LED strip: 11 mm

Dimensions: L2500 x W14 x H16.1 mm (no wings)

L2500 x W26 x H16.1 mm (wings)

Mounting: surface (no wings) / recessed (wings)

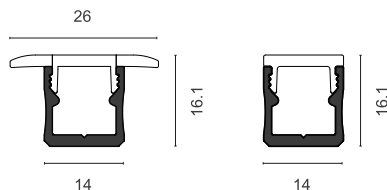

ACCESSORIES

End Caps	EC43SI4043
Covers	CP10PM5C10 (clear - no wings) CP10PM5M08 (milky - no wings) CP10PM6C12 (clear - wings) CP10PM6M11 (milky - wings)
Mounting	MD31SSU110 (clip)
Strain relief	MD40PC4043

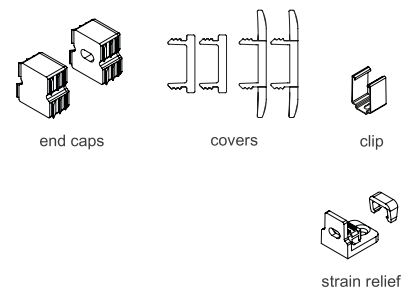

The MULTILine Alu 16 profile also works as a mounting rail for the LineProfil 12 and LineProfil 14-8 plastic profiles. The profiles can be inserted easily from the sides. Especially for installations longer than a meter this is a perfect solution to avoid the bending of the plastic profile. Using a staggered way of mounting, it also ensures a smooth linking of multiple profiles for lengths over 2.5 meters.

Semi linear with milky cover.

CORNERLINE ALU 10 semi linear

SPECIFICATIONS

Model No. PA20AA3021

Material: anodized aluminium

Width for LED strip: 6 mm

Dimensions: L3100 x W10 x H10 mm

Mounting: surface (especially for corners)

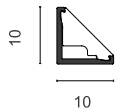

ACCESSORIES

Covers	CP10PM3W44 (white)
Mounting	MD30SSL109 (clip)

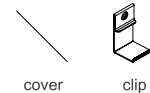

Semi linear with milky cover.

CORNERLINE ALU 16 semi linear

SPECIFICATIONS

Model No. PA21AA3014
Material: anodized aluminium
Width for LED strip: 12.2 mm
Dimensions: L2500 x W16 x H16 mm
Mounting: surface (especially for corners)

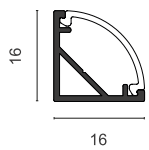

ACCESSORIES

End Caps	EC41PC3030
Covers	CP11PM1C27 (clear) CP11PM1F29 (frosted) CP11PM1M28 (milky)
Mounting	MD31SSL107 (clip)

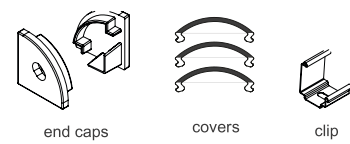

Semi linear with milky cover.

CORNERLINE ALU 19 semi linear

SPECIFICATIONS

Model No. PA21AA3007

Material: anodized aluminium

Width for LED strip: 12.4 mm

Dimensions: L2500 x W18.5 x H18.5 mm

Mounting: surface (especially for corners)

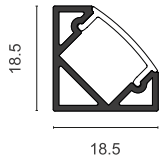

ACCESSORIES

End Caps	EC41PC3013
Covers	CP11PM5C05 (clear) CP11PM5F07 (frosted) CP11PM5M06 (milky)
Mounting	MD31SSL103 (clip)

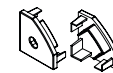

end caps

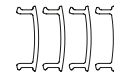

covers



clip

Semi linear with milky cover.

CORNERLINE ALU 30 semi linear

SPECIFICATIONS

Model No. PA21AA3015
Material: anodized aluminium
Width for LED strip: 20.2 mm
Dimensions: L2500 x W30 x H30 mm
Mounting: surface (especially for corners)

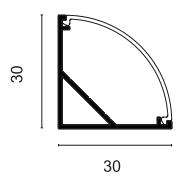

ACCESSORIES

End Caps	EC41PC3034
Covers	CP11PM1C31 (clear) CP11PM1F33 (frosted) CP11PM1M32 (milky)
Mounting	MD31SSL108 (clip)

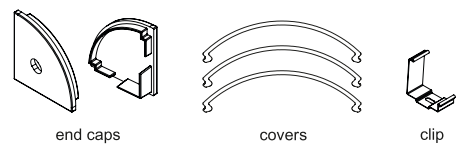

Semi linear with milky cover.

STYLELINE ALU 70

SPECIFICATIONS

Model No. PA21AA5018

Material: anodized aluminium

Width for LED strip: 12.4 mm

Dimensions: L2500 x W26.2 x H70 mm

Mounting: recessed for wall mount

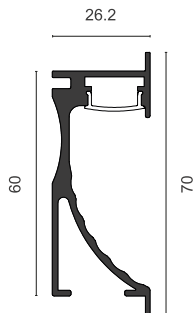

ACCESSORIES

End Caps	EC41PC5039
Covers	CP11PM5C05 (clear)
	CP11PM5F07 (frosted)
	CP11PM5M06 (milky)

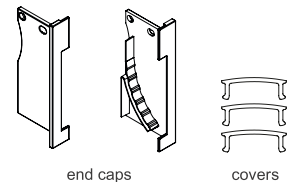

FLOORLINE ALU 9

SPECIFICATIONS

Model No. PA21AA5017
Material: anodized aluminium
Width for LED strip: 12.2 mm
Dimensions: L2500 x W52.3 x H8.4 mm
Mounting: surface

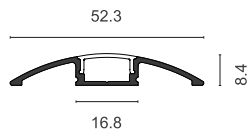

ACCESSORIES

End Caps	EC41PC5036
Covers	CU11PM5A47 (aluminium coated) CP11PM5C05 (clear) CP11PM5F07 (frosted) CP11PM5M06 (milky)

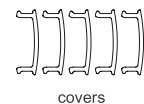
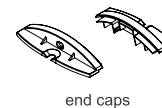

TOPLINE PMMA 5

SPECIFICATIONS

Model No. PP10PM4C08 (clear - frosted)
 PP10PM4F07 (frosted - frosted)
 PP10PM4C13 (clear - white)
 PP10PM4F12 (frosted - white)
 PP10PM4C16 (clear - black)
 PP10PM4F15 (frosted - black)

Material: PMMA

Width for LED strip: 4 mm

Dimensions: L2000 x W7 x H5 mm

Mounting: surface

Wire exit: linear and 90° down

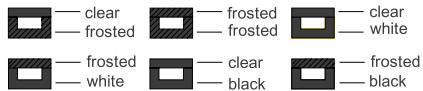

ACCESSORIES

End Caps	EC42SI4004 (endcap 1)
	EC42SI4005 (endcap 2)
Mounting	MD30SSU108 (clip)



*End cap 1: for sealing the profile; no wire exit.

*End cap 2: besides sealing the profile, it offers a linear and 90° wire exit, extending the profile length by 6 mm.

CORNERLINE PMMA 10



SPECIFICATIONS

Model No. PP10PM3C22 (clear)
PP10PM3F22 (frosted)
Material: PMMA
Width for LED strip: 7 mm
Dimensions: L3100 x W10 x H10 mm
Mounting: surface (especially for corners)
Wire exit: linear and 90° x 3

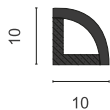

ACCESSORIES

End Caps	EC45SI3000 (endcap set)
Mounting	MD30SSL109 (clip)



*Endcap set: adds 0 mm on one side and 6 mm on the other side to the length of the profile. One side sealing inside the profile, other side 4-ways wire exit.

LINEPROFIL 12

SPECIFICATIONS

Model No. PP10PM4M05 (milky)
 Material: PMMA
 Width for LED strip: 8 mm
 Dimensions: L2500 x W11 x H12 mm
 Mounting: surface
 Wire exit: linear and 90° x 4

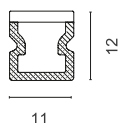

ACCESSORIES

End Caps	EC42SI4007 (endcap set)
Mounting	MD30SSU105 (clip) PA20AA4003 (mounting rail - MULTiline Alu 16) MD31SSU110 (clip - MULTiline Alu 16)



end caps 1



clip



mounting rail
MULTiline Alu 16



clip
MULTiline Alu 16

*Endcap set 1: adds 3 mm on one side and 4 mm on the other side to the length of the profilet, the latter offering a 5-ways wire exit.

The MULTiline Alu 16 profile (see page 35) also works as a mounting rail for the LineProfil 12 and LineProfil 14-8 plastic profiles. The profiles can be inserted easily from the sides. Especially for longer installations (more than 1 meter) this is a perfect solution to avoid the bending of the plastic profile. Using a staggered way of mounting, this also ensures a smooth linking of multiple profiles for lengths over 2.5 meters.

LINEPROFIL 14-8

SPECIFICATIONS

Model No. PP10PM4W03 (opaque white)
 Material: PMMA
 Width for LED strip: 8 mm
 Dimensions: L2500 x W11 x H14 mm
 Mounting: surface
 Wire exit: linear and 90° x 4

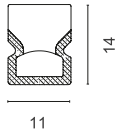

ACCESSORIES

End Caps	EC42SI4006
Mounting	MD30SSU105 (clip) PA20AA4003 (mounting rail - MULTiline Alu 16) MD31SSU110 (clip - MULTiline Alu 16)

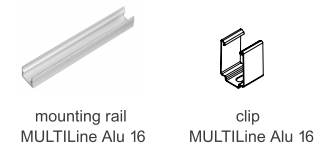
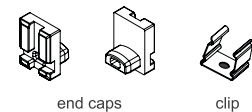

*Endcap set: Adds 3 mm on one side and 4 mm on the other side to the length of the profile, the latter offering a 5-ways wire exit.

The MULTiline Alu 16 profile (see page 35) also works as a mounting rail for the LineProfil 12 and LineProfil 14-8 plastic profiles. The profiles can be inserted easily from the sides. Especially for longer installations (more than 1 meter) this is a perfect solution to avoid the bending of the plastic profile. Using a staggered way of mounting, this also ensures a smooth linking of multiple profiles for lengths over 2.5 meters.

LINEPROFIL 14-10

SPECIFICATIONS

Model No. PP10PM4W25 (milky white)
Material: PMMA
Width for LED strip: 10 mm
Dimensions: L2500 x W13.5 x H14 mm
Mounting: surface / recessed
Wire exit: linear

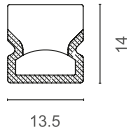

ACCESSORIES

End Caps	EC42SI4007
Mounting	MD30SSU106 (clip)

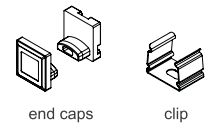

LINEPROFIL 14-12

SPECIFICATIONS

Model No. PP10PM4W26 (milky white)
Material: PMMA
Width for LED strip: 12 mm
Dimensions: L2500 x W15.5 x H14 mm
Mounting: surface / recessed
Wire exit: linear

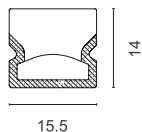

ACCESSORIES

End Caps	EC42SI4008
Mounting	MD30SSU107 (clip)

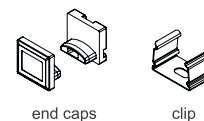

LINEPROFIL 18

SPECIFICATIONS

Model No. PP10PM4W09 (milky white)

Material: PMMA

Width for LED strip: 5 mm

Dimensions: L2000 x W10 x H18 mm

Mounting: surface / recessed

Wire exit: linear

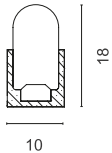

TOPLINE ALU 3511

SPECIFICATIONS

Model No. PA21AA3511

Material: anodized aluminium

Width for LED strip: 12 mm

Dimensions: L3000 x W35.5 x H11.5mm

Mounting: surface

ACCESSORIES

End Caps: EC41PC1031

Covers: CP11PC1M35 (milky)

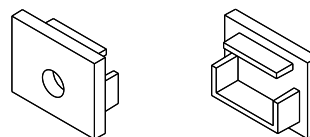
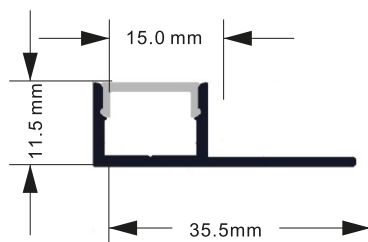

end caps

CORNERLINE ALU 5917

SPECIFICATIONS

Model No. PA21AA5917
Material: anodized aluminium
Width for LED strip: 12 mm
Dimensions: L3000 x W59 x H23.4mm
Mounting: surface

ACCESSORIES

End Caps: EC41PC1031
Covers: CP11PC1M35 (milky)

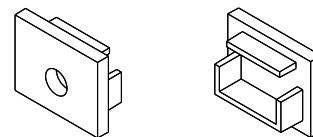
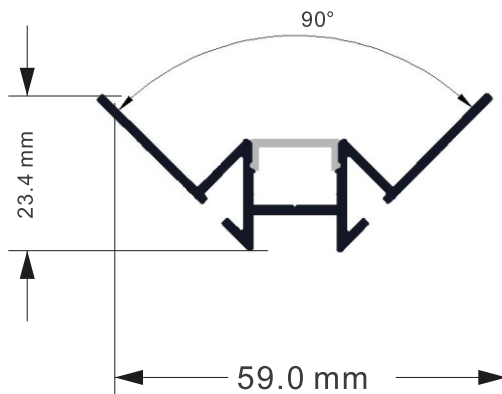

end caps

CORNERLINE ALU 4128

SPECIFICATIONS

Model No. PA21AA4128
Material: anodized aluminium
Width for LED strip: 12 mm
Dimensions: L3000 x W40.5 x H27.7mm
Mounting: surface

ACCESSORIES

End Caps: EC41PC1031
Covers: CP11PC1M35 (milky)

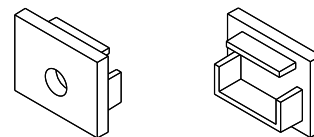
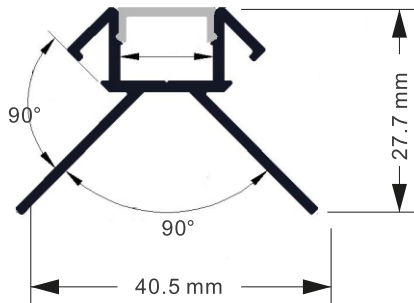

end caps

SUSLINE ALU 6826

SPECIFICATIONS

Model No. PA21AA6826
Material: anodized aluminium
Width for LED strip: 12 mm
Dimensions: L3000 x W68 x H26mm
Mounting: surface

ACCESSORIES

End Caps: EC41PC1031
Covers: CP11PC1M35 (milky)

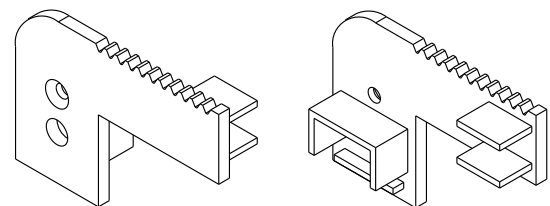
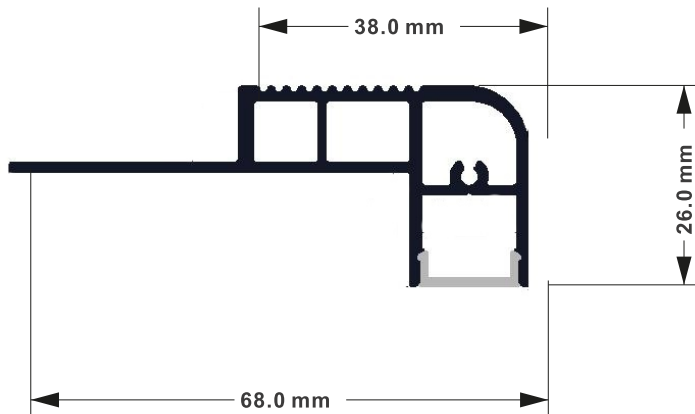

end caps

INLINE ALU 7615

SPECIFICATIONS

Model No. PA21AA7615
Material: anodized aluminium
Width for LED strip: 12 mm
Dimensions: L3000 x W76 x H15mm
Mounting: recessed

ACCESSORIES

End Caps: EC41PC1031
Covers: CP11PC1M35 (milky)

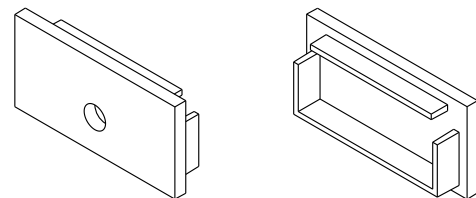
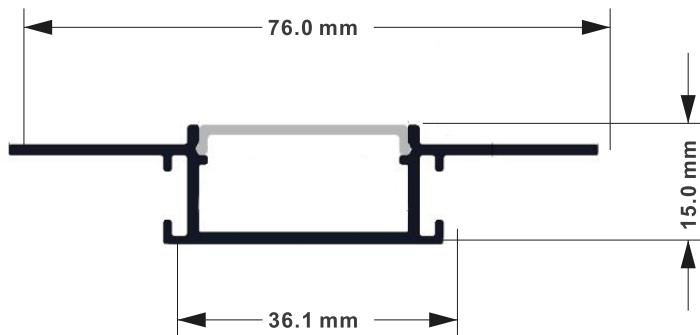
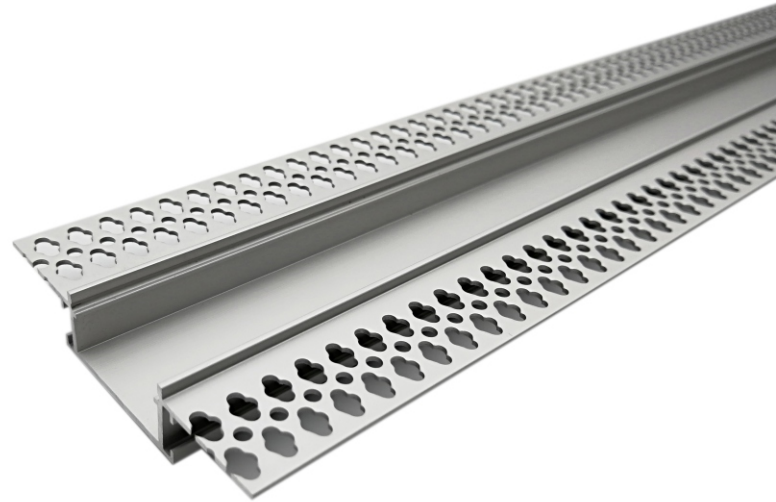

end caps

INLINE ALU 5615

SPECIFICATIONS

Model No. PA21AA5615
Material: anodized aluminium
Width for LED strip: 12 mm
Dimensions: L3000 x W55.5 x H15mm
Mounting: recessed

ACCESSORIES

End Caps: EC41PC1031
Covers: CP11PC1M35 (milky)

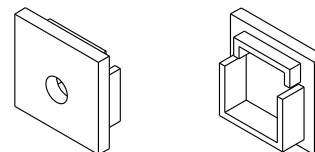
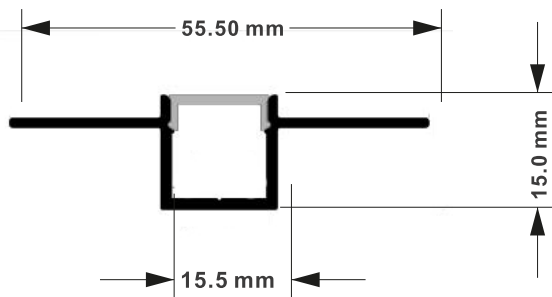

end caps

CORNERLINE ALU 4615

SPECIFICATIONS

Model No. PA21AA4615
Material: anodized aluminium
Width for LED strip: 12 mm
Dimensions: L3000 x W45.7 x H25mm
Mounting: surface

ACCESSORIES

End Caps: EC41PC1031
Covers: CP11PC1M35 (milky)

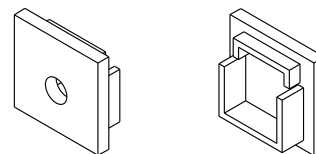
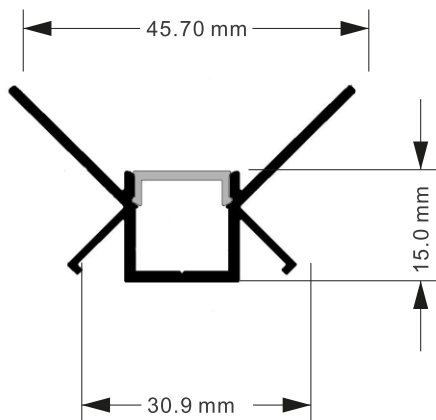

end caps

CORNERLINE ALU 5315

SPECIFICATIONS

Model No. PA21AA5315
Material: anodized aluminium
Width for LED strip: 12 mm
Dimensions: L3000 x W53 x H23mm
Mounting: surface

ACCESSORIES

End Caps: EC41PC1031
Covers: CP11PC1M35 (milky)

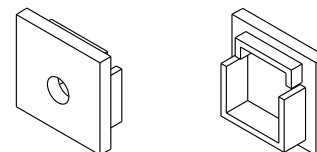
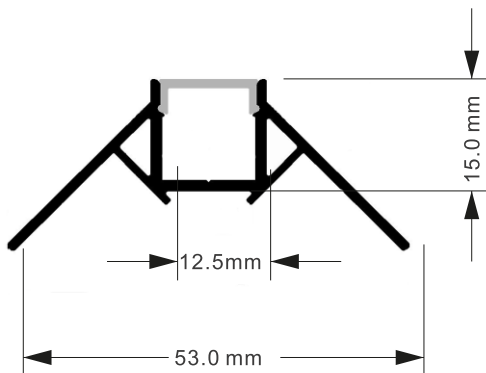

end caps

LUXX Light Technology

LUXX Light Technology (Shenzhen) Ltd.

5th Floor, Building 8
Hui Debao Industrial Park
Bai Huayuan Rd, Guang Ming
Street, Guang Ming District
Shenzhen 518107
China

Phone: +86 755 27049942
Fax: +86 755 29677724
info@luxx.cn
www.luxx.cn

LEDtec GmbH

Abelbachstraße 13
OT Steinhausen
33142 Büren
Germany

Phone: +49 295193838-300
Fax: +49 2951 93838 199
info@ledtec.eu
www.ledtec.eu

LUXX Light Technology (USA) Inc.

4425 Kansas Ave
St. Francis,
WI, 53235
USA

Phone: +1 414 7633141
info@luxx.com
www.luxx.com

Sun Electronics Srl.

Via Leonardo da Vinci 24/A
Corsico (Milan) 20094
Italy

Phone: +39 02 9532 7303
Fax: +39 02 9532 7091
info@sunleds.it
www.sunleds.it